

NL

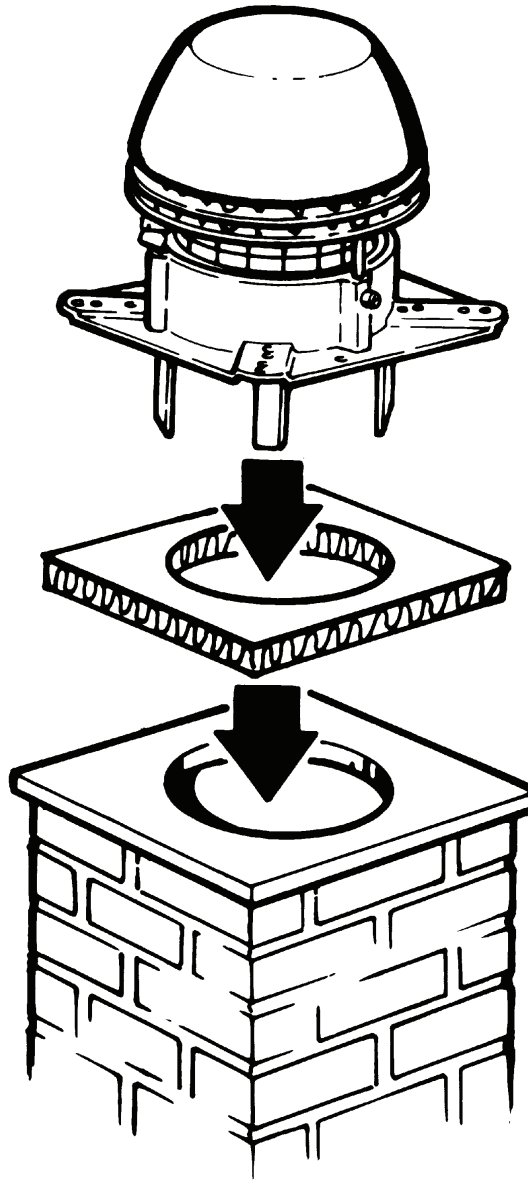
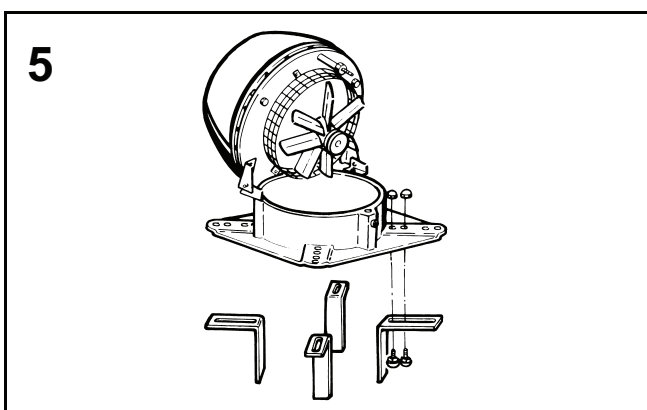
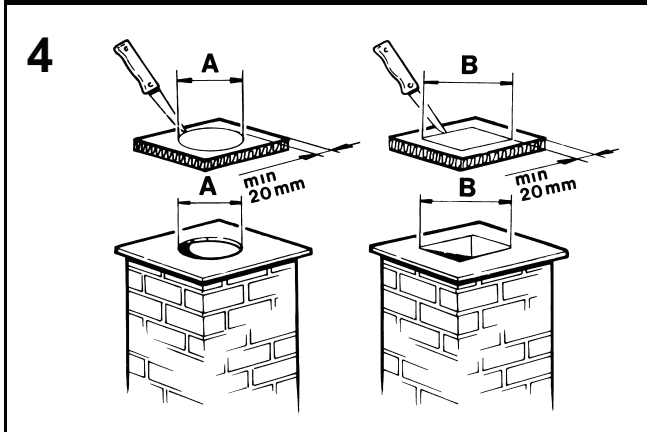
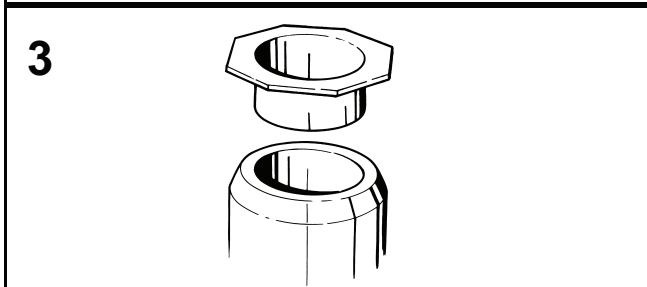
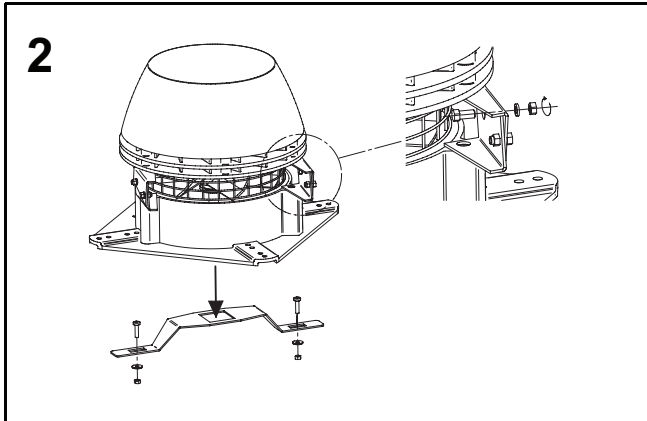
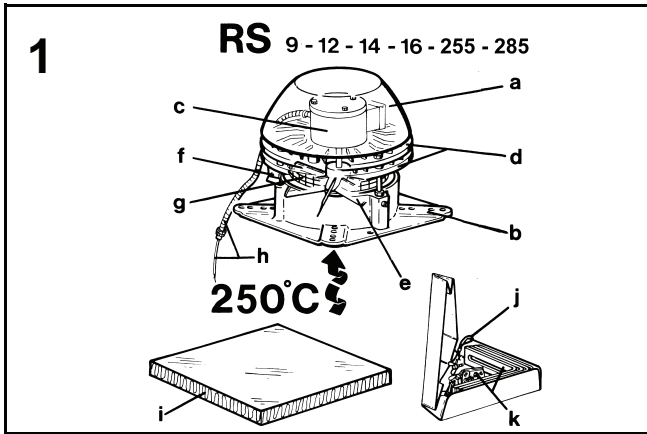

RS

**PLEASE NOTE!**

To avoid a chimney fire please sweep the chimney before mounting the fan.

The chimney fan must always be operating when the fireplace is in use.

Please always read the installation instructions for the EXHAUSTO control unit, before installation of the chimney fan.

1 Product Description

The EXHAUSTO chimney fan type RS is standard supplied with location brackets, armoured cable, safety wire and glass fibre mat for vibration-free mounting. Furthermore, the RS is supplied with wing screw for mounting, if possible.

1.1 Construction

Fig. 1 The chimney fan RS is constructed for horizontal discharge and is made of cast aluminium. The RS is available in six different sizes, RS 9, 12, 14, 16, 255 and 285. RS 9 - 16 are provided with a stainless steel vane and RS 255 - 285 are with an open cast aluminium impeller. Both types can be opened for service and cleaning purposes.

Chimney Fan	Weight
RS009-4-1	9 kg
RS012-4-1	14 kg
RS014-4-1	18 kg
RS016-4-1	25 kg
RS255-4-1	14 kg
RS285-4-1	20 kg

The RS consists of the following main parts:

- a: Hat
- b: Base plate
- c: Motor
- d: Cooling plates
- e: Vane/ impeller
- f: Hinge
- g: Mesh
- h: Armoured cable and connecting cable
- i: Glass fibre mat
- j: Safety wire
- k: Location brackets, bolts and nuts

2 Installation**2.1 Mechanical installation**

Fig. 2 Transport safety device:

RS 9: Remove transport safety device from vane and make sure that the vane can revolve without hindrance.

RS 14/16: Before mounting, the transport safety device on the hinges must be removed.

Fig. 3 The chimney fan is designed for mounting directly on a brick chimney with a level top in good condition. A flange is used when mounting on a steel chimney. The flange, which is to be mounted directly on top of the chimney, is provided with a long spigot that makes fastening unnecessary, except from the safety wire.

Fig. 4 Measure the inside diameter of the chimney and cut a corresponding hole in the glass fibre mat. When making the hole, make sure that min. 20 mm connecting surface is left.

Please notice that the aluminium foil on the glass fibre mat is to face upwards against the chimney fan.

Fig. 5 Mount and fasten the location brackets in the marks in the underside of the base plate by means of the bolts and nuts supplied. Please notice that the bolt is to be mounted from beneath.

Please notice that the figures 6-11 are on the back of the installation instruction.

Fig. 6 Adjust the distance between the location brackets to the inside diameter of the chimney, and clamp the nuts. Please allow for 2-4 mm space between location brackets and chimney to ensure that no vibrations from the fan are transmitted to the chimney.

Fig. 7 The chimney fan is now ready for mounting. Place the glass fibre mat on top of the chimney, the aluminium foil facing upwards, and place the chimney fan on top of the mat.

Fig. 8

- Mount the safety wire in the chimney (1). Use the supplied screw and rawl-plug in brick chimney and the self-cutting screw in steel chimney. Then mount the wire through the hole in the base plate and into the wire lock.
- Tighten the safety wire slightly and tighten the wire lock (2), so that the chimney fan is secured when opened for service and cleaning purposes.
- Mount the weatherproof isolation switch (not EXHAUSTO delivery) on the side of the chimney (3) within reach, and mount the armoured cable, with the connecting cable, from beneath and through the threaded entry into the switch.

Fig. 9 Before starting up, make sure that:

- the nuts in the location brackets are tightened (4).
- the chimney fan is closed and the screw tightened (5).
- the safety wire is clamped to the chimney (6).
- the safety wire and the wire lock are tightened (7).
- the grommet on the armoured cable is fastened (8).
- the end-user is aware of the fact that the chimney fan must always be operating when the fireplace/boiler is in use.



2.2 Electric connection

Fig. 10 The specifications of the chimney and motor appear from the mounted product labels. All one-phased types are adjustable. The electric connection is made by means of the electric chart. Please see the installation instructions for EXHAUSTO controls. All chimney fans require extra protection in accordance with power current regulations. A weather-proof isolation switch is to be installed right in front of the fan, breaking all poles.

Min. length of break = 3 mm

Max. supply protection = 10 Amp.

A lightning conductor is to be installed according to Building Regulations and local Bye-laws.

Connecting cable and electric connection		Infinitely electronically adjustable	Protection
RS009-4-1 RS012-4-1	brown = L blue = Nreg yellow/green= 	Yes	The motor stands blocking (impedance protection)
RS014-4-1 RS016-4-1 RS255-4-1 RS285-4-1	brown = L blue = Nreg yellow/green= 	Yes	The motor is to be overload protected

3 Service and cleaning



Fig. 11 The motor in the EXHAUSTO chimney fan RS has special ball bearings, which are sealed, greased-for-life, and maintenance-free. Under the specified working conditions (250°C flue gas temperature), the life expectancy of the bearings is 10.000 working hours. If replacement of the bearings is required, this should be carried out by EXHAUSTO SERVICE only or corresponding specialists.

Inspection and cleaning are to be done when required (at least once a year), depending on sort of fuel, in the following way:

- Turn off the fan on the weatherproof isolation switch. Please wait until the rotation has stopped.
- Loosen the screw (5) and lift up the top section. Due to the hinges and the safety wire, the fan remains open during cleaning.
- Clean the vane/ impeller carefully with a filling knife or a brush.
- Check and clean by means of a filling knife or a brush the Mesh and the underside of the base plate in order to prevent soot deposits.
- The open chimney fan also provides free access to the chimney.
- In case of vibrations in the chimney fan, possibly due to unbalance in consequence of dirty vane / impeller, the cleaning is to be repeated. If the impeller has balancing blocks, these must not be removed.

4 Technical data

The sound level to ambients is under 67 dB(A) when the distance to the chimney fan is larger than 1 m. This is valid when the RS is correct mounted. For further information, please see the product leaflet. The RS standard type is constructed for a flue gas temperature of max. 250°C. At higher temperatures, max. 300°C, the chimney fan is to be mounted on dilution bolts type RSD or vibration bolts type SVD-RS in connection with flanges instead of glass fibre mat. Please see special instructions.

5 Guarantee

EXHAUSTO offers a 2 years' factory guarantee with the fan, from date of invoice.

The installation must only be made by competent persons.

EXHAUSTO reserves the right to make alterations without previous notice.



EXHAUSTO Ltd.

4/5 Centurion Court, Brick Close, Kiln Farm · GB-Milton Keynes MK11 3JB
Tel. (01908) 261196 Fax (01908) 261186
E-mail: info@exhausto.co.uk www.exhausto.co.uk

DK: EU-Overensstemmelseserklæring GB: Declaration of Conformity D: EU-Konformitätserklärung F: Déclaration de conformité de l'Union Européenne	N: EU-Samsvarserklæring NL: EU-Konformiteits verklaring S: EU-Överensstämmedeklaration SF: EU-Vaatumustenmukaisuusvakuutus IS: ESS-Samræmisstaðfesting
EXHAUSTO A/S Odensevej 76 DK-5550 Langeskov DANMARK	
erklærer på eget ansvar, at følgende produkter: hereby declares that the following products: erklært hierdurch auf eigene Verantwortung, daß folgende Produkte: déclare, sous sa propre responsabilité, que les produits suiv- ants:	erklærer på eget ansvar at følgende produkter: veklaard dat onderstaande produkten: deklarerar på eget ansvar, att följande produkter: vastaa siltä, että seuraava tuote: Staðfesti á eigin ábyrgð, að eftirfarandi vörur:
RS09, RS12, RS14, RS16, RS255, RS285	
som er omfattet af denne erklæring, er i overensstemmelse med følgende standarder: were manufactured in conformity with the provisions of the fol- lowing standards: die von dieser Erklärung umfaßt sind, den folgenden Normen: auxquels s'applique cette déclaration sont en conformité avec les normes ci-contre:	som er omfattet av denne erklæring, er i samsvar med føl- gende standarder: met de onderstaande standard koderingen: som omfattas av denna deklaration, överensstämmer med föl- jande standarder: jota tämä selvitys koskee, on seuraavien standardien mukai- nen: sem eru meðtalin i staðfestingu Pessari, eru i fullu samræmi við eftirtalda staðla:
EN60 335-1, EN60 332-2-80, DS/EN ISO 12100-1: 2003, DS/EN ISO 12100-2: 2003	
i.h.t bestemmelser i direktiv: in accordance with: entsprechen gemäß den Bestimmungen der folgenden Richtlinien: suivant les dispositions prévues aux directives:	i.h.t. bestemmelser i direktiv: voldoen aan de heironder gestelde eisen: enligt bestämmelserna i följande direktiv: seuraavien direktiivien määräysten mukaan: med tilvisun til ákvarðana eftirlits:
Maskindirektivet: the Machinery Directive: Richtlinie Maschinen: la Directive des Machines:	Maskindirektivet: voor machines: Maskindirektivet Konedirektiivi: Vælaeftirlitið:
98/37/EF/-EEC/-EWG/-CEE	
Lavspændingsdirektiv: the Low Voltage Directive: Niederspannungsrichtlinie: Directive Basse Tension:	Lavspenningsdirektivet: laagspanning: Lågspänningsdirektivet: Pienjännitedirektiivi: Smáspennueftirlitið:
73/23	
EMC-direktivet: and the EMC Directive: EMV-Richtlinie: Directive Compatibilité Electromagnétique:	EMC-direktivet: voor EMC: EMC-direktivet: EMC-direktiivi: EMC-efirlitið:
89/336, 92/31	
Langeskov, 10.06.2004	
Adm. direktør Managing Director Geschäftsführender Direktor Président Directeur Général Peter Hermansen	Adm. direktør Algemeen directeur Verkställande direktör Toimitusjohtaja Frankvemdastjóri
